



## LED Mini Wall Pack - 26 watts with photo cell

SKU#104001





**LED Mini Wall Pack with brand new design has upgraded for security lighting, it's widely used at pathway, hallway, perimeter, patio, entrance, stairway, house, garden, garage, yard, warehouse, factory, store, street, porch. With premium driver and Dust-to-Dawn photocell, save up to 80% on energy and oprating cost. Inside with 50000-hour Lumileds LED chipset as light sources, it's ideal solution to replace conventional fixtures.**

- Dusk-to-Dawn photocell available - Auto turn on at dusk and off at dawn
- Unique slim shape design - Uniform lighting distribution via PC lens
- Easy and fast installation - Direct mounting on wall or with J-Box
- High efficiency output - light efficiency is up to 120LPW
- Waterproof IP65 rating - suitable for all kinds of weather
- Good energy saving - save 80% electricity cost compared to traditional lamp
- 5 Years Warranty for whole fixture and power supply

## Specifications

Item No.	FDWPS-26-LED-5K-120-277V
System Power(±5%)	26W
<b>Electrical Data</b>	
Input Voltage	100-277 VAC
LED Driver	MINGLIGHT Driver
Power Frequency	50/60Hz
Power Factor	>0.9
THD	<20%
<b>Optical Data</b>	
System Efficacy	136.2 (±5%) Lm/W tested based on 5000K Ra70
Luminous Flux (±5%)	3542LM
LED Chip	Lumileds SMD3030
Beam Angle	110°
Light Color	5000K
CRI	>70 Ra
UGR	<19
<b>Temperature Data</b>	
IP Rate	IP65 Rated
Operating Temp	-40° ~ 131° F (-40° ~ 55° C)
Ambient Temp	-4° ~ 104° F (-20° ~ 40° C)
Storage Temp	-40° ~ 158° F (-40° ~ 70° C) R.H.≤85%
Lifespan	≥50000Hrs (Ta=30°C@L70) Operating
Fixture Material	Die casting Aluminium body
Safety Certification	ETL, DLC
Warranty	5 Years
<b>Dimension &amp; Packing Data</b>	
Product size (LxWxH)	232 x 152 x 91 mm (7.61" x 4.99" x 2.99")
Net Weight (Carton)	11.4 KGS (25.13 LBS)
Gross Weight (Carton)	12.5 KGS (24.25 LBS)
Carton size (LxWxH)	59 x 34.5 x2 6.5cm (23.23" x 13.58" x 10.43")
Qty/Carton	10 PCS

<b>L.E.D. vs HPS / MH Equivalence</b>	
LED	26W
HPS / MH	100W

## Dimensions

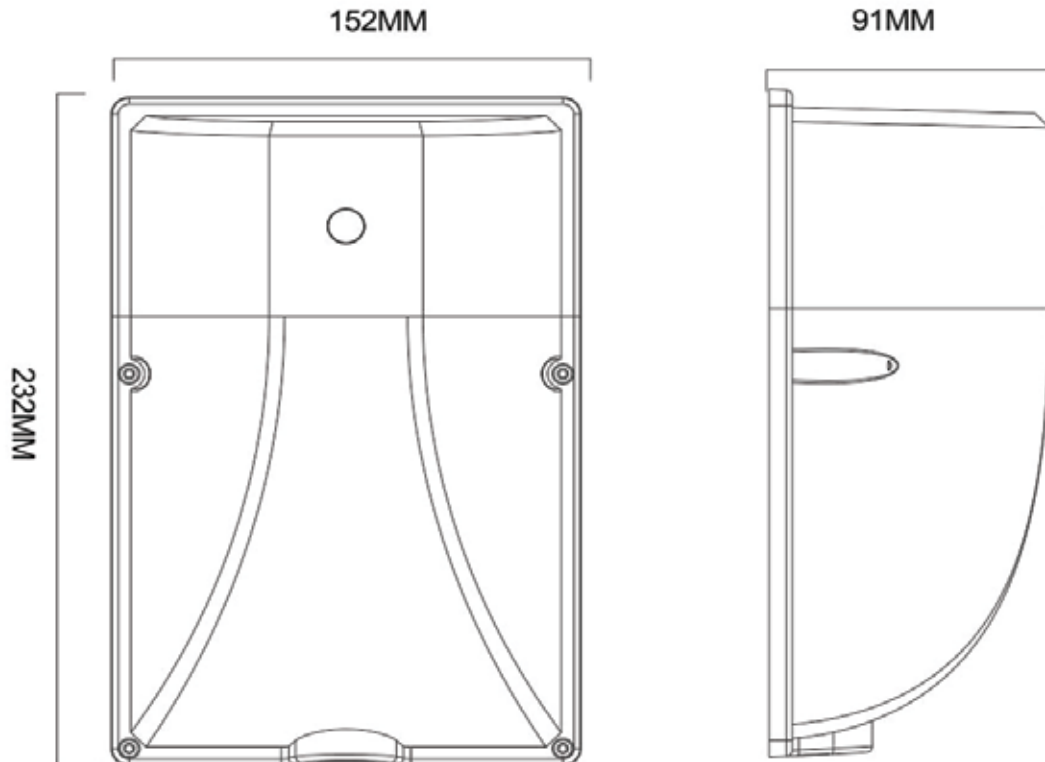

## Installation Diagram

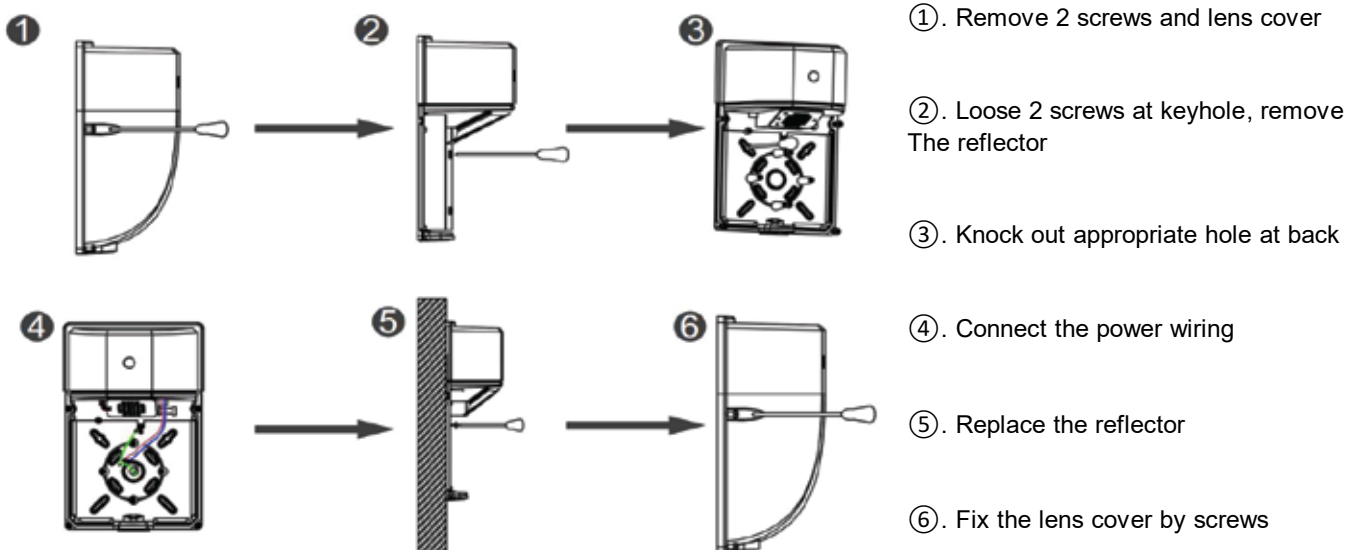

## Technical Specifications

### #Certificate

#### RoHS approved

This product is tested by independent lab. with all green material.

#### ETL / DLC approved

This product have passed ETL testing and is fully DLC approved.

#### IESNA LM-79 and LM-80 Testing

FDL fixture have been tested by independent lab. in accordance with IESNA LM-79 and LM-80 Testing

#### Color Stability:

LED color temperature is warranted to shift no more than 200K in CCT over a 50000 hours.

#### Color Uniformity:

FDL's range of CCT follows the guidelines of the American National standard for specification for the chromaticity of Solid State Lighting (SSL) Products, ANSI C78.377-2017

### #Installation

#### IES Classification:

80° beam angles, the lighting output produces a oval shape distribution to cover the area.

#### Mounting:

This product is direct mounting on wall mounting or with J-box  
The application including Warehouse, patio, entrance, stairway, house, Garage, outdoor facilities.

### #LED Characteristics

#### Lifespan

50000 hours LED lifespan based on IES LM-80 results and TM-21 Calculation.

#### Color Consistency

7-step MacAdam Ellipse binning to achieve consistent one by one color.

### #Smart Engine

#### Dimming Driver

1-10V Dimming optional

#### Smart Sensor

Photocell optional

### #IP Rating

Ingress Protection rating of IP65  
IP65 for dust and water

#### Greenity:

Mercury or UV free. RoHS compliant components. Package boxes are made with recyclable material.

### #Smart solution options

Description	Pictures	Function
Photocell		Auto turn on at dusk/night and off at dawn/daytime

### #Trouble Shooting

Problem	Possible Cause	Solutions
LEDs stop working	The power line is improperly connected.	Reconnect the power cable.
	The power plug is loose.	Firmly plug the power in.
	The LED driver malfunctions.	Replace with new driver.
	The LED chip is damaged.	Replace with new LEDs.
LEDs flash on and off	The output of the driver is abnormal.	Replace with new driver.
	The LED chip breaks down.	Replace with new LED chip.

### #Warranty

FDL warrants that our LED products will be free from defect in material and workmanship for a period of 5 years from the data of delivery to the end user including coverage of light output, color stability, driver performance and fixture.

## Photometrics

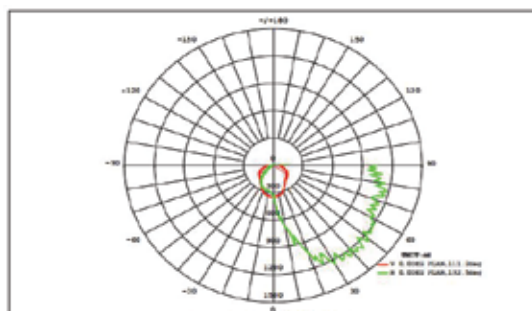

DATA OF LAMP		Eff:107.23lm/W	
MODEL	ML-WPA-26W-5000K	Imax (cd)	1362
NOMINAL POWER(W)	26	AVAILABILITY (%)	93.7
RATED VOLTAGE (V)	277	Avai. FLUX(lm)	2663
NOMINAL FLUX(lm)	2841.66	LOR (%)	100.0
LAMPS INSIDE	1	TOTAL FLUX(lm)	2842
TEST VOLTAGE (V)	276.5	θ @50%(H,V)	111,132DEG

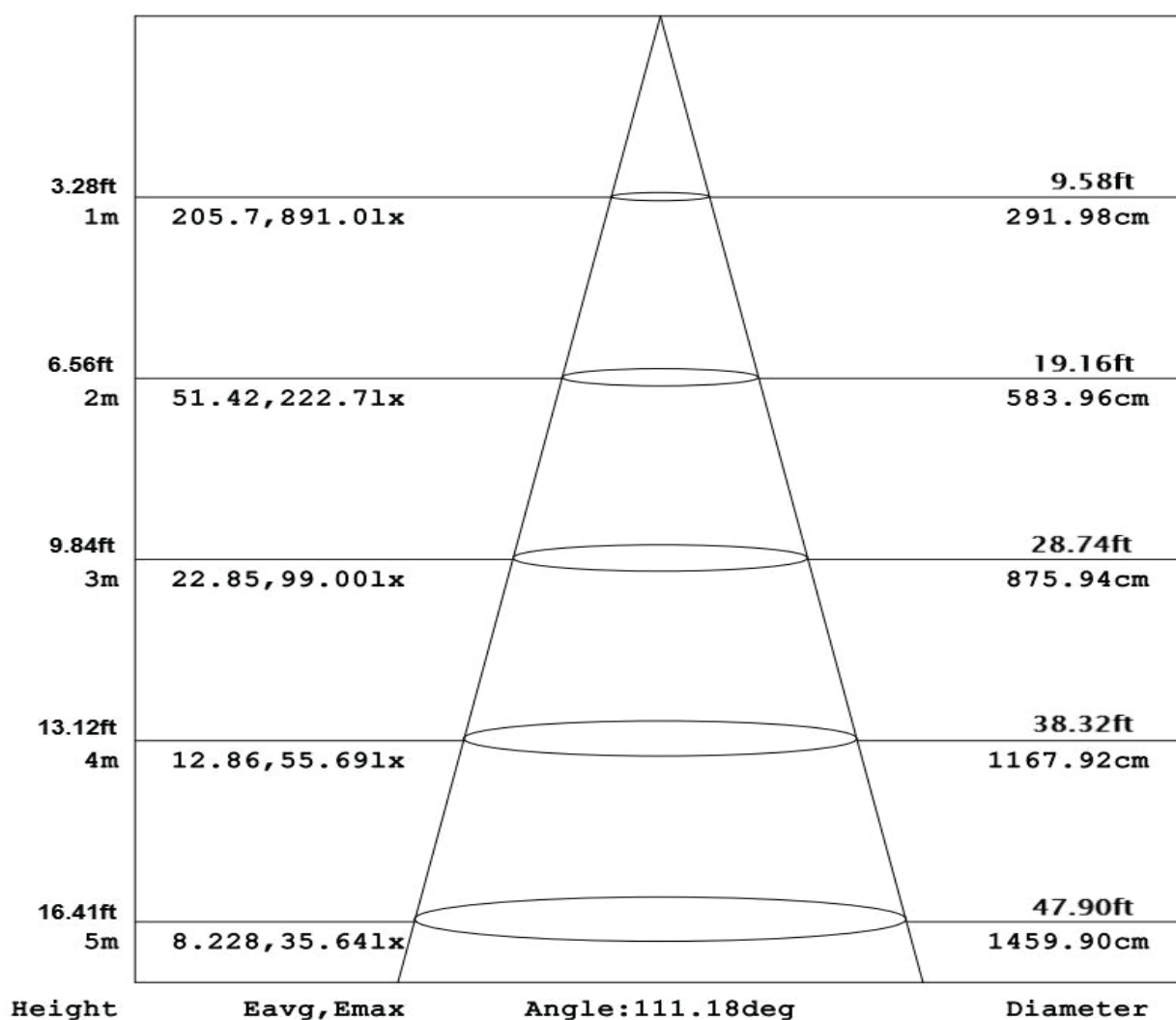

mounting height for best illumination effect: 6 to 20 feet (2 - 6 meters)



Wall Pack is widely used in pathway, hallway, perimeter, patio, entrance, stairway, house, garden, garage, yard, warehouse, factory, store, street, porch

## Project Cases

