

Installation Instruction for LED Running Man Exit Sign

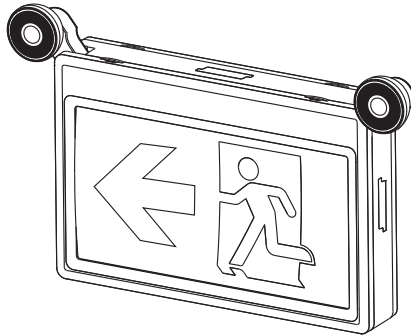

IMPORTANT SAFETY NOTICE

READ AND FOLLOW ALL SAFETY INSTRUCTIONS

- Review the diagrams thoroughly before beginning.
- All electrical connections must be in accordance with local codes, ordinances and the National Electrical Code.
- Disconnect power at fuse or circuit breaker before installation or service.
- Do not use outdoors.
- Do not mount in hazardous locations or near gas or electric heaters.
- Do not let power cords touch hot surfaces.
- Equipment should be mounted in locations and at certain height where it will not be subject to tampering by unauthorized personnel.
- The use of accessory equipment is not recommended by the manufacturer.
- Do not use this equipment other than intended use.
- Allow battery to charge for 48 hours before first use.
- All service should be performed by qualified personnel only.

MOUNTING INSTRUCTION

THE FIXTURE IS SUITABLE FOR WALL, SIDE AND CEILING MOUNTING

1. Open front cover and assemble 2pc lamp heads on the frame. Remove the corner inserts if needed. (See Fig.2)
2. Knockout appropriate mount screw hole and cable hole, mount back plate on the wall after feeding building AC Supply Cable into back plate. (See Fig.3)
3. For ceiling and side mounting purpose, remove the mounting hole cover on the top or side of unit, assemble the canopy. (See Fig.4, Fig.5, Fig.6)
4. Attach crossbar to junction box, set the longer blade of crossbar touching the J-Box.
5. Route the proper wires through mounting hole out of housing.
6. Make electrical connections inside the J-Box use the wiring diagram.
7. Push excess wire into J-Box, use screws to tighten canopy to crossbar so canopy is securely fastened and tight against the wall.
8. Attach battery connector to PC Board, restore front cover on unit, adjust position of lamp heads as needed.
9. For double face installation (only for ceiling and end mounting), remove the back plate and replace with the extra front plate provided. (See Fig.8)
10. If pictogram direction assembled is not suitable, change the pictogram direction or replace pictogram accordingly. (See Fig.7)

WALL MOUNTING-Fig.3

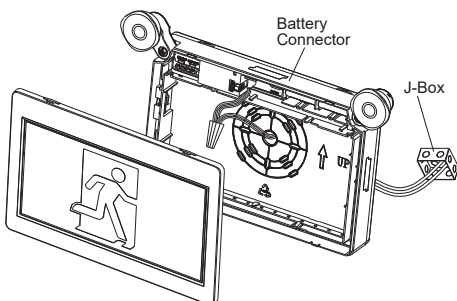

SIDE MOUNTING-Fig.4

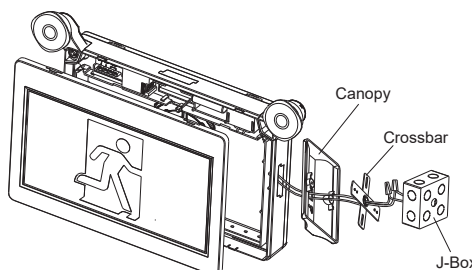

CEILING MOUNTING-Fig.5

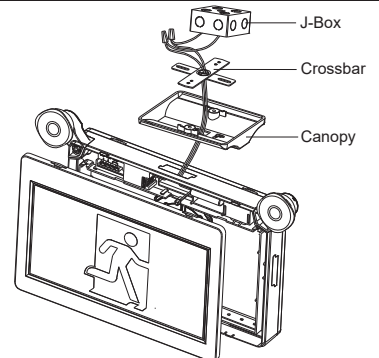

CANOPY ASSEMBLE-Fig.6

Insert canopy into housing at 20 degree angle and twist.
Quick snap is now firmly locked.
CAUTION: Trying to remove canopy is locked in place may cause damage

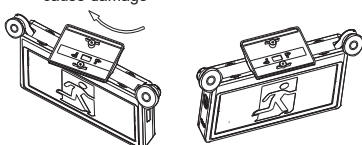

CHANGE DIRECTION OF PICTOGRAM-Fig.7

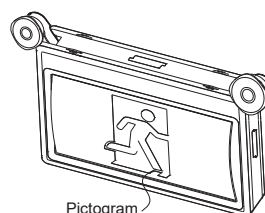

DOUBLE FACE INSTALLATION-Fig.8

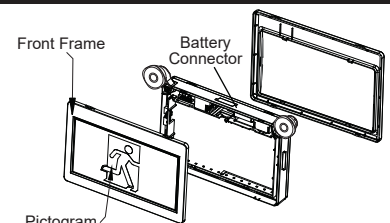

WIRING DIAGRAM - Fig.1

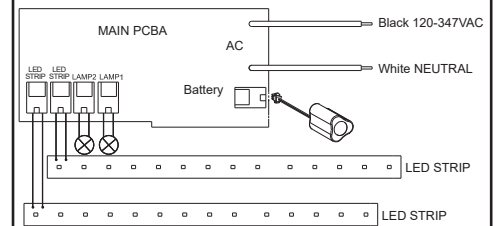

AC WIRING

1. Connect the white wire to neutral and connect the black wire to live.
2. Cap unused leads.

CAUTIONS

MAINTENANCE

- NOT REQUIRED, Replace the batteries as needed according to ambient conditions. We recommend the equipment be tested regularly in accordance with local codes.

OPERATION

- Press the test button, the LED heads will turn on and the LED indicator will turn off. Release the test button, LED indicator will turn on and the LED heads will turn off.

TROUBLE SHOOTING GUIDE - IF LED HEADS OR INDICATOR DOES NOT ILLUMINATE, CHECK THE FOLLOWING:

- Check AC Supply, verify the unit has 24 hours of AC supply.
- Unit is short circuited or battery is not connected.
- Battery discharge. Permit unit to charge for 24hrs then re-test.
- If above trouble shooting hints do not solve problem, contact seller for assistance.

ASSEMBLY LAMP HEADS-Fig.2

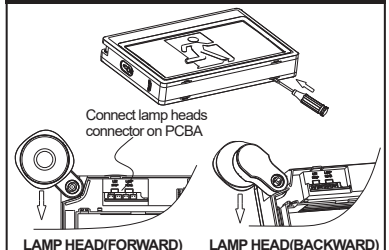

1. Open front cover by flat screwdriver.
2. Insert the lamp heads at the corners of the main frame. Select direction of lamp head before inserting.
3. Connect connector on the lamp near to the connector on the PCBA.
4. Remove the corner inserts if needed.